

HEAVY DUTY.



AXN | HEAVY DUTY

**IT'S IN THE NAME.
IT'S IN THE PRODUCT.**

MECHANICAL SUSPENSION

KEY FEATURES

- ▶ *Reliable, proven design*
- ▶ *High-strength material for longer life*
- ▶ *Simple maintenance*
- ▶ *Available in single and multiple axle configurations*
- ▶ *Industry Competitive Warranty*
- ▶ *Available in underslung and overslung configurations.*
- ▶ *Various spring seat height variations allow for a wide range of ride height solutions*
- ▶ *Available in under-, straddle-, or flange-mount configurations*



▶ Available with Rockwell American Springs

UNDERSLUNG SPECIFICATIONS

MODEL	H (in.)*	L1 (in.)	L2 (in.)	L3 (in.)	S (in.)
TMN448BL007S	6.25*	19.0	49.0	43.5	0.75

- ▶ *Single Axle Kit Weight (.75" Seat): 158 lbs. (w/o springs)*
- ▶ *Tandem Axle Kit Weight (.75" Seat): 344 lbs. (w/o springs)*

* Using High-arch Spring. Ride Height will vary depending on specified spring.

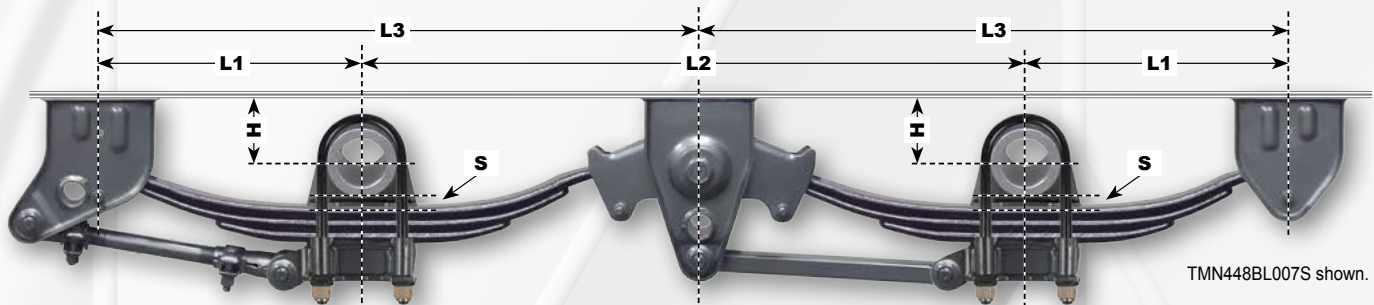

OVERSLUNG SPECIFICATIONS

MODEL	H (in.)*	L1 (in.)	L2 (in.)	L3 (in.)	S (in.)
TMN448BT007S	13.38*	19.0	49.0	43.5	0.75
TMN448BT012S	13.88*	19.0	49.0	43.5	1.25
TMN448BT017S	14.38*	19.0	49.0	43.5	1.75
TMN448BT022S	14.88*	19.0	49.0	43.5	2.25

- ▶ *Single Axle Kit Weight (.75" Seat): 146 lbs. (w/o springs)*
- ▶ *Tandem Axle Kit Weight (.75" Seat): 320 lbs. (w/o springs)*

* Using Low-arch Spring. Ride Height will vary depending on specified spring.

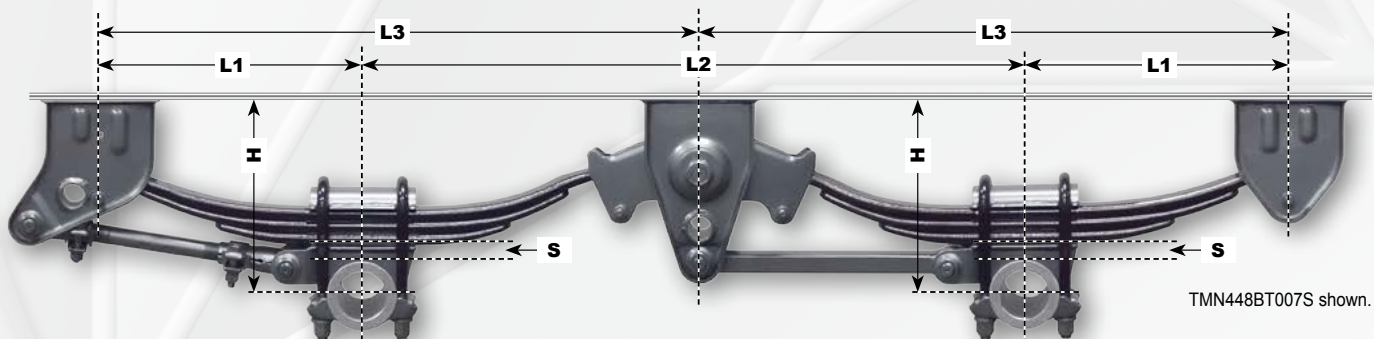

MECHANICAL SUSPENSION FEATURES & BENEFITS



AXN HEAVY DUTY MECHANICAL SUSPENSION NOMENCLATURE

Product	Nominal Rating (lbs)	Kit Type	Suspension Type	Seat Height	Spring Configuration	-	Variant
TMN Trailer Mechanical Under Mount	224 22,400	A Complete Single Axle	T Top Mount (Overslung)	007 = 0.75" (1.0" for Underslung)	K Kit WITHOUT Springs		Axxx Fabricated
TMS Trailer Mechanical Straddle Mount	448 44,800	B Complete Tandem Axle	L Low Mount (Underslung)	012 = 1.25" 017 = 1.75" 022 = 2.25"	S Suspension WITH Springs		Cxxx Cast
TML Trailer Mechanical Flange Mount	672 67,200	C Complete Tridem Axle					
		P Axle Connection Kit		Additional Seat Height Options Available			
		H Susp. Hanger Kit	X Use "X" when ordering "H" or "E" Kits	000 = No Seat Included when ordering Expansion Kit			
		E Susp. Expansion Kit					

FEATURES & BENEFITS

HANGERS

✓ Fabricated Front & Rear Hangers (Under-mount shown)

- A E-coated for corrosion resistance
- B Drain holes on sides and low points on spring seat help prevent corrosion
- C Grade 8 torque arm fasteners with reinforced mounting flanges

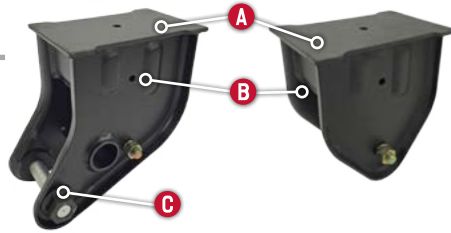

✓ Fabricated Center Rocker Hanger (Under-mount shown)

- A E-coated for corrosion resistance
- B Industry standard Grade 8 capscrew & nut style pivot bolt for ease of maintenance
- C Grade 8 torque arm fasteners with reinforced mounting flanges

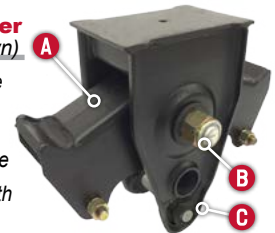

CONNECTIONS

✓ Underslung Axle Seats (.75" height shown)

- A .375" steel, E-coated for corrosion resistance
- B Notched spring seat plate for ease of U-bolt alignment during assembly



✓ Overslung Axle Top & Bottom Plates

- A E-coated for corrosion resistance
- B Notches in Top Plate for ease of U-bolt alignment during assembly
- C Fully welded Top Plate with inset capped ends to reinforce load area under U-bolt

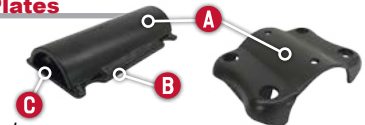

✓ Underslung Spring Seat

- A .375" steel, E-coated for corrosion resistance
- B Robust Top & Bottom Plates



✓ Overslung Axle Seat (.75" height shown)

- A .375" steel, E-coated for corrosion resistance
- B Notches in Top Plate for ease of U-bolt alignment during assembly



✓ U-Bolts

- A Industry standard .875" U-bolts



✓ Adjustable Radius Rod

- A Fabricated rod ends, E-coated for corrosion resistance
- B "Crush-plate" stabilizer to help avoid crushing clamp

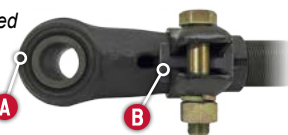

✓ Fixed Radius Rod

- A Tubular, seamless arm & rod ends, E-coated for corrosion resistance
- B Long-life rubber bushings



KITTING AND DELIVERY OPTIONS

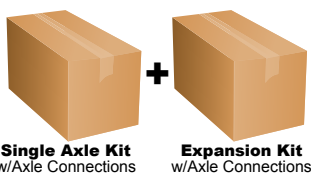

Single Axle Kit
w/Axle Connections

Expansion Kit
w/Axle Connections



Add One More Expansion Kit for Tridem Application

KIT

BULK



✓ **YOUR CONTAINER,**
✓ **YOUR WAY, DIRECT!**

MIX & MATCH TRAILER KITS:
Suspensions, Axles, Landing Gear or all Three!

5534 National Turnpike
Louisville, KY 40214 • USA
502.749.3200
www.AXNHeavyDuty.com